

M/Y LA DATCHA

YACHT FOR CHARTER

PERSHING 9X

2019
MALTA Flag

The 28m La Datcha yacht was built in 2019 by Pershing. She features an exterior design by Fulvio de Simoni and an interior by Fulvio de Simoni. She cruises at 38 knots and reaches a top speed of 41.0 kn. She can sleep up to 9 guests taken care of by a crew of 3.

The Pershing 9X is a work of true state-of-the-art nautical design, the perfect combination of wonder and amazement and an awe-inspiring blend of luxury and technology.



With its futuristic materials and engines, the Pershing 9X is a revolutionary Sports Yacht that merges the Pershing thrill with "X Generation" excellence to produce an unprecedented nautical experience. The Pershing 9X combines elegance and technology to maximize on board pleasure. The aft deck offers extremely generous spaces for relaxing thanks to a lounge, dining area and a large sun pads.



La Datcha has 2 other key area for lounging and sun-bathing: The bow area with large sun-beds and a seating area and the newly designed fly bridge. The interior décor boasts the best Italian brands, such as the leather-upholstered "Interior in Motion" helm station which celebrates the partnership between Pershing and Poltrona Frau.



The Pershing 9X offers performance at the very top of its class and unique comfort thanks to its quiet running even at high speeds and its lack of roll at anchor thanks to 2 Seakeeper NG9 gyro stabilisers. The fully integrated engine, navigation and monitoring systems ensure an unprecedented yachting experience in terms of performance and trim optimization, with customized displays on the monitors.



On the port side of the deck a companionway leads to the lower deck with four cabins: the full-beam master suite in the middle, the VIP to bow and the two guests rooms along the corridor. The latter share the third bathroom, and both feature two beds plus the possibility of adding a third bunk.



Master cabin



Bathroom details



VIP Cabin



Tenders and Toys

Tender: Yes

Water toys available on board:
snorkeling equipment,
paddleboard.

Any additional equipment such as
Jet-Ski and SeaBob must be
requested in advance.



Technical Specs

LA DATCHA Specifications

Type:	Motor Yacht
Builder:	<u>Pershing SpA</u>
Model:	9X
Year:	2019
Hull:	Planning
Refit:	-
L.O.A.:	28.09m (92'2)
Beam:	6.23m (20'5)
Draft:	1.80 mt (5' 90")
Classification:	CE "A" category
Gross Tonnage:	79 grt
Crew:	3
Guests:	8
Cabins:	8 guests accommodated in four cabins including a full-beam master cabin complete with walk-in wardrobe, along with two twin cabins and a VIP in the bow.
Engines Make:	MTU
Engines:	2 x 2638 hp
Model:	12V2000M96L
Consumption:	ND
Cruise Speed:	36 knots
Max Speed:	42 knots
Exterior Designer:	<u>Fulvio de Simoni</u>
Interior Designer:	<u>Pershing SpA</u>
Passengers capacity:	12 px cruiser 8 px cruiser day

Layout

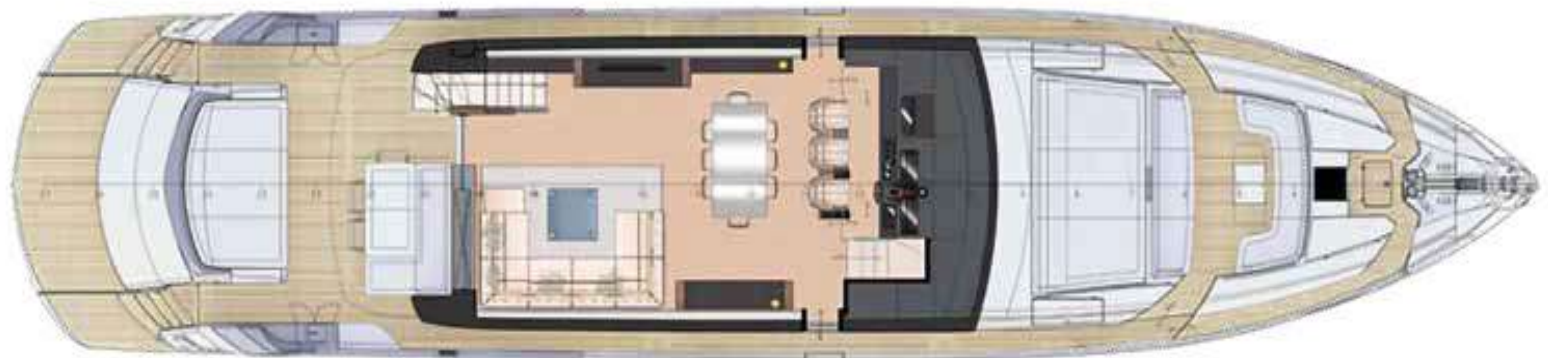

Price list

- Charter rates – Retail price list :

	Weekly rate	Daily rate
• June	TBC	TBC
• July	TBC	TBC
• August	TBC	TBC

- **Our offer includes:**

- taxes, crew (3 people) , mooring, insurance cat. A (full insurance), licenses, transfer from the villa to the harbour and back – soft drinks –
- weekly rate : two free daily lunch for six people

- **Not included:**

- Italian Vat (22%),fuel, galley, mooring taxes in different harbor of our base

Reservation terms

- Security deposit: yes
- In advance, at reservation 50 %
- To settle 30 days before emb. 50 %
- Possibility One Way: yes

Contact



- **Spice Yacht srl**

- **Mobile:** +39 348 0549109

- **Phone:** +39 0187 765602

Reg.Office : Piazza Caduti Per La Liberta'N.30, 19124 La Spezia

HQ : Via Giacomo Doria N.74, 19124 La Spezia

Web: www.spiceyacht.com | **Mail:** info@spiceyacht.com